

Malinsy showcases contemporary living, dramatic detailing

The furnished Malinsy estate model by BCB Homes presents a blending of coastal Mediterranean influence and classic contemporary design.

Located within The Estuary at Grey Oaks and designed by Stofft Cooney Architects, the Malinsy offers four bedrooms, of which one is a cabana suite, library, formal living and dining areas, a family room with breakfast nook, a wine cellar, four full baths and a powder room. The home has 5,223 square feet of air-conditioned living space and 7,272 square feet under roof including the outdoor living room, covered entry and three-car garage.

The striking two-story entry provides an inviting vision of graceful arches that define the formal living area and set the tenor for the rest of the home.

Interior designer Pat Wilson Wise, ASID, of PW Square Inc. Interior Design, employed a décor that draws upon the drama of dark woods and against a backdrop of crème. The interior theme is classic modern, reminiscent of Hollywood romanticism in the 1930s and '40s.

The formal living area features conversation seating that focuses on a marble fireplace framed with mahogany. Built-in art shelves on either side of the fireplace are lighted and enhanced with mahogany trim echoing the curved shape of the arches.

The post-and-beam detail provides visual interest to the vaulted ceiling while adding a comfortable human scale to the room.

An arched doorway leads to the formal dining room, which features an oval table in a dark finish, side chairs with crème upholstery and host and hostess chairs upholstered in the animal print. A centerpiece of the dining room is the 1930s Paris designed umbrella chandelier. Twin Jacques Garcia-designed lamps light the sideboard.

The arch detail is repeated in the windows and along the hallway that leads to the library and the master suite.

Grasscloth in a muted pear covers the walls of the office, a diversion from the color palette throughout the rest of the home. Contemporary furnishings, a glass-topped work table, mahogany cabinetry, red accents and floor-to-ceiling crème draperies provide continuity.

Double doors provide an imposing entry for the master suite.



The family room of the Malinsy model opens to the outdoor living area through motorized sliding glass doors, revealing views of the pool and golf course. Courtesy/Tani Hurley Public Relations

A cove ceiling with recessed lighting offers a relaxing ambience at night, while transom windows on either side of the bed enhance the room's natural light. The contemporary theme is maintained with dark mahogany furnishings, light bedding and crème draperies, and accentuated with bold black-and-crème checked wool area rugs. Brazilian cherry wood flooring, coffee-colored chairs and throw pillows in animal prints add a warming tone. The suite includes a sitting area overlooking the spa and terrace. A private entry leads to the pool area.

In the master bath, the marble flooring repeats the bold theme with squares contrasting black granite against the light-colored marble. Custom wood cabinets and granite countertops add to the elegant theme. The whirlpool tub is encased with marble. The walk-through glass shower

enclosure features a rain forest showerhead and body wash. The bath includes twin vanities and two private water closets, one with bidet. As an added convenience, the linen closet includes a personal washer and dryer.

An elegant wood staircase with designer metal railings lead to the upstairs and two guest suites, each with a private bath and balcony. The home is designed for an elevator to be added.

Views from the back of the home sweep across the patio and pool to the fourth fairway of The Estuary golf course.

The leisure room provides a comfortable retreat for family and friends with an L-shaped sofa in cream and contrasting dark mahogany coffee table and sofa table.

The adjacent island kitchen provides breakfast bar seating as well as an informal dining area

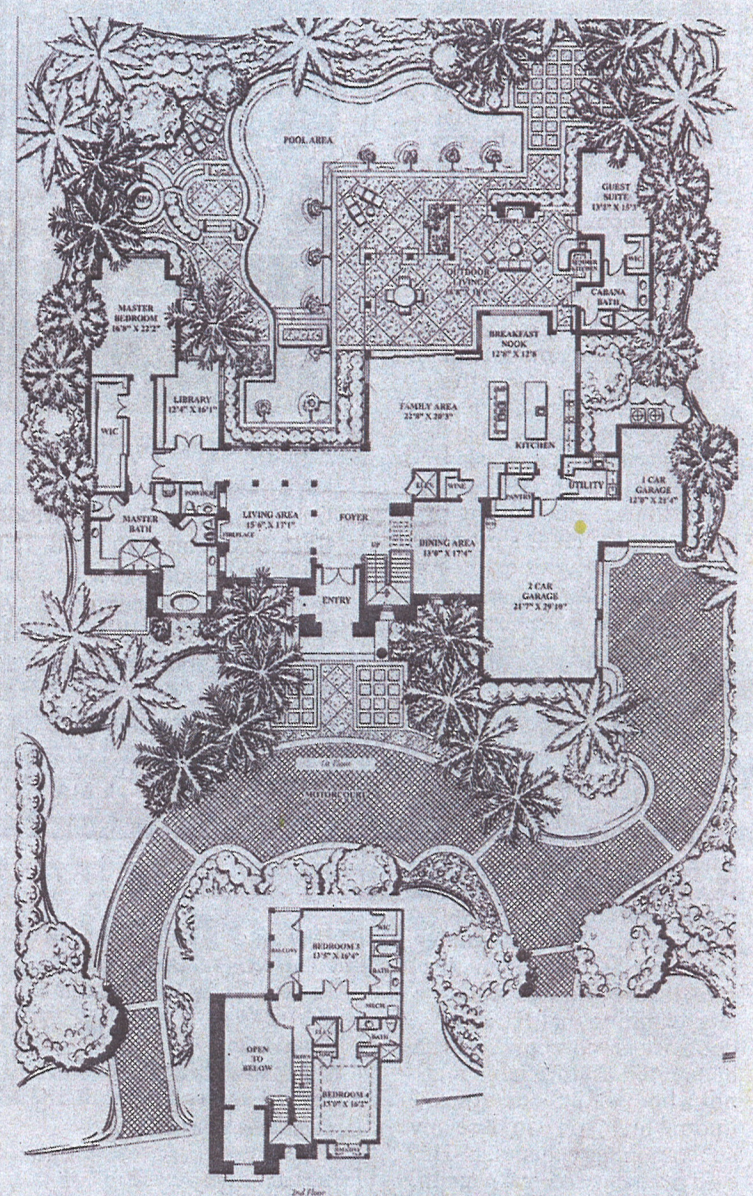

Shown is the floor plan for BCB Homes Malinsy model.

with views of the patio and pool. Equipped with a Wolf range and top-of-the-line appliances, the kitchen features granite countertops and custom cherry cabinetry. There is a wine closet and a walk-through butler's pantry which provides convenient service to the formal dining area.

Motorized sliding glass doors offer uniquely easy access to the outdoor living areas, while the covered patio has the added advantage of roll down screens.

Owners and guests are invited to take full advantage of Florida's wonderful weather with a conversation area surrounding the fireplace, a fully-equipped summer kitchen with Dacor grill and a dining bar. The appeal of the infinity pool is augmented with a waterfall, emitters and a raised spa. A surround of hand-painted fired tile provides a truly custom finish.

The detached cabana suite,

with its own entrance, provides guests with added privacy. The cabana bath may be closed off from the bedroom, and with its own poolside entry, doubles as a pool bath.

Convenience and efficiency are included in this exceptional home with touch pad audio, lighting and mood control. The Malinsy has numerous energy-saving features, such as high-efficiency multizone air-conditioning system with digital thermostats, high-performance Andersen windows, and energy-efficient 120-gallon hot water heaters with recalculating system.

The Malinsy is offered at \$4.995 million, with designer furnishings.

For more information or to view the model, contact BCB Homes in Naples at 3696 Enterprise Ave., Suite 100.